

INSTALLATION INSTRUCTIONS

NATURAL WOVEN SHADES

Rechargeable Simplicity



Thank you for your purchase. This shade has been custom built for you from the highest quality materials. To avoid errors and save valuable time, please read these instructions before installing your new shade.

TOOLS YOU WILL NEED

1. Pencil or Marker
2. Measuring Tape
3. Flat-Head Screwdriver
4. Phillips Screwdriver
5. Carpenter's Level
6. Power Drill
7. Mounting Fasteners
8. Paper Clip

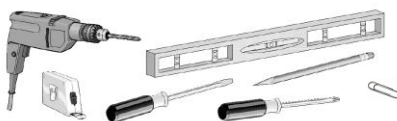



Mounting Surface	Fastener
Drywall, Plaster	Wall Anchors, Expansion Bolts (Not Provided) 
Metal	Sheet Metal Screws (Not Provided) 
Wood	No. 6 Hex Head Screws (Provided) 

TABLE OF CONTENTS

Getting Started	Page 2
Installation	Page 2-3
Charging the Motor Battery	Page 3-4
Shade & Remote Setup	Page 4-6
Replacing Battery in the Remote.....	Page 7
Trouble Shooting/Child Safety/Care	Page 7
Warranty	Page 8

GETTING STARTED

All of the required installation components are wrapped in your package along with these instructions.

NOTE: Some parts may vary depending upon your chosen mounting options, whether intermediate brackets are required or your chosen control system options.

STANDARD PARTS:

- Outside Mount Installation Brackets
- Inside/Ceiling Mount Brackets (optional)
- Extension Brackets (optional)
- Spacer Blocks (optional)
- Hold Down Brackets (optional)
- Screws
- Charger (purchased separately) – to recharge the motor
- Solar Panel (optional) – to recharge the motor
- Remote (purchased separately) – required to operate the shade

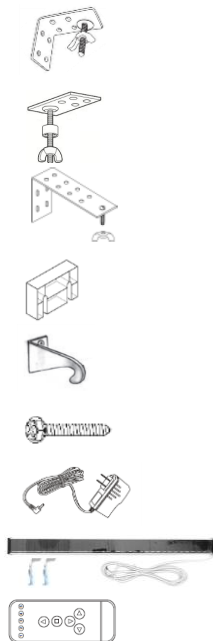

INSTALLATION

With proper installation, operation, and care, your new shades will provide years of beauty and performance. Please thoroughly review this instruction booklet before beginning the installation.

Mounting Types



If the installation brackets are mounted correctly, the rest of the installation process will follow easily. To prepare for this important first step, review the mounting types and basic window terminology illustrated.

Prior to mounting the brackets, add any clearance depth required to avoid obstructions such as window cranks or handles.

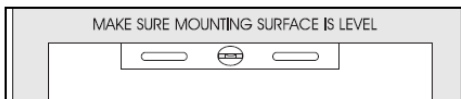
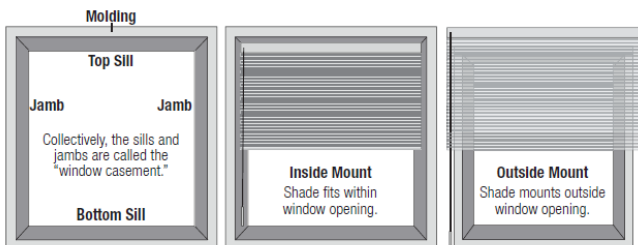
Make sure mounting surface is level. Brackets must be in line and level. Shim brackets if necessary. **The head rail must be level for the shade to operate properly.**

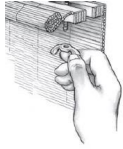

Inside Mount:

Inside Mount Shades		
	Flush Mounting Depth Requirement: 3 1/4" Min. Mounting Depth Requirement: 1 1/2"	
<ul style="list-style-type: none">• Hold the shade inside the window frame. Center the shade so the space between the end of the headrail and edges of the window frame are equal.• Spaced brackets evenly. Using the installation bracket as a template, measure to the center of the brackets and mark the hole locations with a pencil for drilling.• Install the brackets with screws provided. Make sure brackets are level with one another.• Remove the wing nuts from the bolts and hold the shade with the bracket bolts coming through the routed slots on each end of the headrail, reinstall the wing nuts onto the bolts and hand tighten.		

Outside Mount:

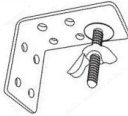
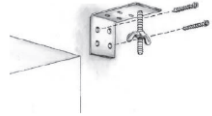
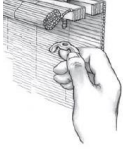
Outside Mount Shades		
	Min. Flat Vertical Surface: 1"	
<ul style="list-style-type: none">• Center the shade over the window opening at the desired height.• Spaced brackets evenly. Using the installation bracket as a template, measure to the center of the brackets and mark the hole locations with a pencil for drilling.• Install the brackets with screws provided. Make sure brackets are level with one another.• Remove the wing nuts from the bolts and hold the shade with the bracket bolts coming through the routed slots on each end of the headrail, reinstall the wing nuts onto the bolts and hand tighten.		

CHARGING THE MOTOR BATTERY

When the shade begins to operate slower than normal, or only beeps when you attempt to operate, it is time to charge the battery.

Charge with a Charger:

- Plug the 8.4v charger into the charging port on the motor.
- Plug the charger into an electrical outlet.
- A red light on the charger indicates that the battery is charging.
- To fully charge the batteries, allow the batteries to charge for at least 1 hour after the light on the charger turns green.
- A typical charge cycle can take between 4-6 hours.

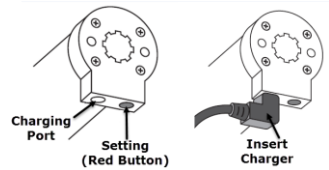

Charge with Solar Recharge Unit:

Determine solar recharge unit placement. The solar recharge unit should be placed at the location where gets the maximum amount of sunlight per day. **In most cases this can be achieved by mounting the unit directly to the glass with double sided tape.**

Brackets are provided if attaching to the glass is not possible. The brackets may be mounted several different ways depending on the application (window depth, window width, etc.). Check depth clearance behind the shade before mounting.

The unit requires 19" minimum window width to mount horizontally.

Mounting Options:

Tape Method – Cut the tape to fit inside the white border as shown. Clean the ends of the solar panel where the tape will go with rubbing alcohol. When dry, remove the release liner from one side of the double sided tape and adhere them to face of the panel. Make sure to put the tape on the face (black side) of the panel.

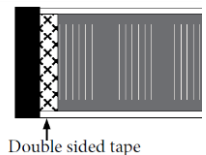

- Clean the window surface with rubbing alcohol. When dry, remove the release liners and attach the solar panel to the glass, pressing firmly to adhere.
- Connect solar recharge unit to motor charging port

Bracket Method – If using brackets, set the bottom groove of the unit onto the bottom bracket hook. Then press the top of the unit until it snaps into place. If space is limited it may be easier to attach the brackets to the solar unit before screwing the brackets in place.

- **Inside Mount Bracket** can be mounted behind or next to shade mounting bracket.
- **Inside Mount Extended.** Bottom portion of the bracket may be lowered if needed for more sun exposure.
- Bracket can be mounted behind or next to shade mounting bracket. Note: only two of the holes are threaded.
- **Inside Mount with Top Reversed.** The top portion of the bracket may be reversed if necessary depending on space. Bracket can be mounted behind or next to shade mounting bracket.
- **Outside Mount.** This method will provide the least amount of sun exposure. Bracket can be mounted next to shade mounting bracket.
- Install Solar Recharge Unit – If space is limited it may be easier to attach the brackets to the solar unit before screwing the brackets in place.
- Connect solar recharge unit to motor charging port

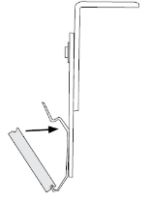
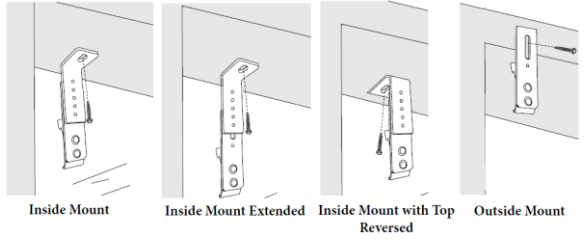

SHADE & REMOTE SETUP

Make sure shades are mounted securely before operating.

REMOTE CONTROL

For added protection, remote controls arrive:

- With a protective film, please remove this film prior to use.
- **All shades are shipped un-linked to Remote.** Install all shades prior to linking to the remote.



Upper and lower limits are set at the factory.

Please follow sections below to link the shade to the remote and set the limits (if needed) along with favorite position if desired.

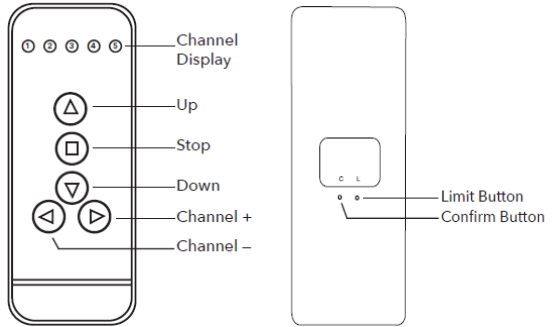

Step 1: Link Remote Control to the Shade

(One shade at a time)

Before linking the remote, determine which shade(s) you want on which channel. Remote has 5 channels. Select the desired channel with the **CHANNEL + or -** buttons. The channel indicator light will illuminate the channel that is on.

Single Shade:

1	Press SETTING button on the motor until the shade jogs.	Release the button when shade jogs.
2	Press and hold the CONFIRM (C) button until the shade jogs.	Shade jogs, shade is linked to that remote and channel.

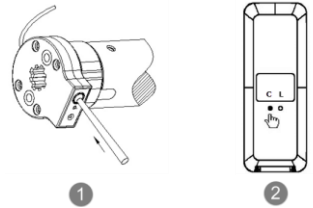

If all 5 lights are lit, the remote will control all 5 channels at once. All shades linked to the remote will also automatically be programmed to the "ALL" channel.

Press and hold the **UP** or **DOWN** buttons for 2 or more seconds to raise or lower the shade. Shade will move to full limits after button has been pressed for more than 2 seconds.

Press the **STOP** button to stop the shade anywhere along the window.

Tapping the **UP** or **DOWN** buttons for less than 2 seconds will move the shade in short steps. Holding the **UP** or **DOWN** buttons for more than 2 seconds before releasing will operate the shade to programmed limits.

- If limits are set correctly, skip step 2 and continue to **Step 3: Setting Favorite Position** if desire to set a favorite position.
- If limits need to be reset, please follow instructions under **Step 2: Set Limits**.

Step 2: Set Limits (Lower & Upper Limit must be set at the same time, cannot be set independently) **Lower limit must be set before Upper limit			
Lower Limit:			
1	Press and hold LIMIT (L) button on remote	Release this button when shade jogs.	
2	Press DOWN button	Lower the shade	
3	Press STOP when the shade is near the desired lower limit.	Shade stops	
4	Press either UP or DOWN button to adjust to final limit.	Shade moves step by step to precisely adjust lower limit.	
5	Press CONFIRM (C) on remote.	Shade jogs, this sets the lower limit.	
Upper Limit:			
6	Press UP button	Shade goes up	
7	Press STOP when the shade is near the desired upper limit.	Shade stops	
8	Press either UP or DOWN button to adjust to final limit.	Shade moves step by step to precisely adjust upper limit.	
9	Press CONFIRM (C) button until shade jogs.	Setting is completed when shade jogs.	

****Test the shade**, making sure shade stops at both lower and upper limits. If shade does not stop at desired location, repeat instructions under **Step 2: Set Limits**.

Step 3: Setting Favorite Position			
1	Use the UP or DOWN buttons to position the shade.	Stop at the desired "Favorite" position.	
2	Press and hold LIMIT (L) button, then also press UP button	Release both buttons when the shade jogs.	
When the shade is at either the upper or lower limit, simply press the STOP button to bring the shade to the "favorite" position, make sure the shade has been stopped for at least three seconds before pressing the STOP button.			

- ❖ If no other shades to link, programming is complete.
- ❖ If there are more shades to link but on "different channel" follow all of the steps above.
- ❖ If have more shades to link to the "same channel" please **UNLINK (Step 4)** the programmed shades also on that channel. **Follow all prior instructions for the remaining shades. All programmed shades on the same channel need to be unlinked first before linking a new shade and setting its' limits.**

Step 4: Unlink Remote from the Shade			
1	Select channel motor is on. Press and release CONFIRM (C) button on remote 3 times.	Shade jogs, shade is unlinked	

- ❖ After settings on all shades are completed for the same channel, select the desired channel and follow instructions under **Step 5: Link Remote Control to the Multiple Shades**. All Limits previously set for each shade will be restored.

Step 5: Link Remote Control to Multiple Shade

Before linking the remote, determine which shade(s) you want on which channel. Select the desired channel with the **CHANNEL +** or **-** buttons. The channel indicator light will illuminate the channel that is on.

Multiple Shades:

1	Press SETTING button on the motor until the shade jogs.	Release the button when shade jogs.
	Repeat above step for all shades that will be controlled by the same channel.	
2	Press and hold the CONFIRM (C) button until all the shades jog.	Shades jog, program have been done.

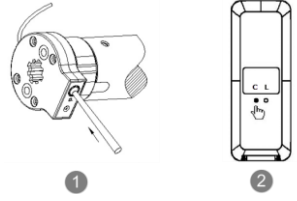

Remote has 5 channels. If all 5 lights are lit, the remote will control all 5 channels at once. All shades linked to the remote will also automatically be programmed to the "ALL" channel.

Change Motor Rotation (Direction)

(Only needed when shade is operating in opposite direction)

1	Press UP button	If shade goes up, do nothing. If shade goes down, please continue with following steps.
2	Press and hold LIMIT button, then press STOP button	Release both buttons when shade jogs.
3	Press UP button	Shade goes up, rotation direction has been corrected.

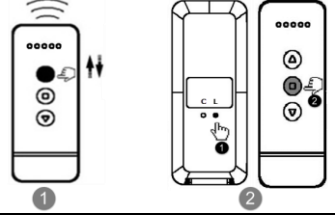

Cloning additional remote

1	Remote A (motors are programmed to this remote) Press and hold LIMIT (L) button then also press CONFIRM (C) button	Release both buttons once shade jogs
2	Remote B: Press CONFIRM (C)	Shade jogs again, remote B has programmed with the shade.

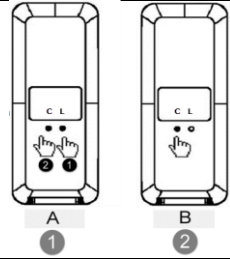

Delete settings from all other remotes

1	Remote A: Press LIMIT (L) button, then press DOWN button	Release both buttons once shade jogs. All setting in other remotes are deleted except remote A.
---	--	---

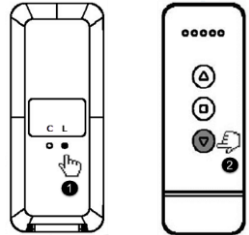

Charging time:

The motor takes approximately 4 hours to be charged when power is low. We recommend leaving the charger in for an extra hour after the indicator turn green. To protect the rechargeable batteries inside the motor, **charger must be unplugged when fully charged.**

REPLACING THE BATTERY IN THE REMOTE

Remove the battery tray from the remote by inserting a fingernail into the indentation on the back of the remote. To avoid the battery falling out of the remote, remove the tray while the remote is face up.

Insert the new battery (CR2430 lithium) into the battery tray so that the writing is facing up when the remote is face up. Slide the tray back into the remote.

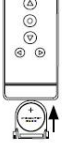

CHILD SAFETY



WARNING

For more safety information call 1-888-501-8364 in the U.S. or 1-866-662-0666 in Canada.

TROUBLESHOOTING

PROBLEM	SOLUTION
The shade does not work or runs slowly.	Recharge the motor.
The shade only goes in one direction.	The limit setting was unsuccessful and needs to be reset.
The shade raises or lowers unevenly.	Check that the installation brackets are level and aligned. Shim the brackets, if necessary.
Shade goes up when the down button is pushed and goes down when the up button is pushed.	Press the Limit button on the underside of the remote and Stop button at the same time. Hold until the shade jogs once. The shade should now move in the correct direction.
The indicator light on the remote does not light up or the remote-controlling range becomes shorter.	Replace the battery in the remote (CR2430 Lithium)
Indicator light on the remote is flashing.	Check on confirm or limit button behind the remote, make sure it's not stuck under the remote housing.

CARE

Woven Woods are made of the highest quality materials for extended wear. If it is not damaged or exposed to a great deal of direct sunlight, it is not unrealistic to expect years of enjoyment with minimal care. Raising and lowering shades periodically helps reduce most natural dust accumulation. If additional cleaning is desired, shades can be lightly brushed or carefully cleaned with a soft vacuum brush attachment. You can also use 3M Scotch guard spray on shades for added stain protection.

IMPORTANT NOTE:

Woven Woods are hand crafted from a variety of quality natural bamboo, rattan, reeds, jutes and wood materials. As such, there is an inherently greater corresponding variation in color, grain, texture, cracking and warpage in the final manufactured shade. These variations are considered acceptable and are part of the unique beauty of woven woods.

DUSTING: Regular light dusting with a feather duster is all the cleaning that is needed in most circumstances.

VACUUMING: Use a hand-held vacuum with low suction for more thorough dust removal.

CAUTION: Do not immerse woven wood shades in water. Do not ultrasonically clean woven wood shades.

WARRANTY INFORMATION

Lifetime Limited Warranty covering our Custom Made Blinds

We extend this lifetime limited warranty to the original purchaser. This warranty applies only to manually operated Custom Products properly installed in the window, door or interior area for which they were intended. Installation of the product must be in accordance with accompanying instructions. The product cannot be modified. It is the purchaser's responsibility to maintain and clean the product in compliance with the instruction provided. The product must be used only in the window for which it was purchased. Damage to the product resulting from misuse, abuse, direct exposure to salty air or discoloration due to sunlight or the passage of time is not covered by this warranty.

This warranty does not apply to conditions caused by normal wear and tear upon the product. This warranty is exclusive and in lieu of all other obligations, liabilities or warranties. In no event shall the Manufacturer be liable for incidental or consequential damages or for any other direct or indirect damage, loss, cost, expense or fee. Some states do not allow the exclusion or limitation of incidental or consequential damages, so this exclusion or limitation may not apply to you.

In the event of a defect under this warranty, we will repair or replace the product, at our option, provided it is returned to our store. Our warranty obligation excludes shipping charges and labor costs for measuring and installation. Repairs will be made with like or similar parts. This warranty gives you specific legal rights, and you may have other rights which vary from state to state.

Notes: Motorization Systems are warranted for five years from the date of purchase. Specialty Blinds and Shades are warranted for one year from the date of purchase.

This warranty does not apply to Commercial Orders.

